



Shaftwall Details



SCAFCO Disclaimer

All data, specifications and detail contained in this publication are intended as a general guide for using SCAFCO's products. These products should not be used in design or construction without an independent evaluation by a qualified engineer or architect to verify the suitability of a particular product for use in a specific application. SCAFCO assumes no liability for failure resulting from the use or misapplication of computation, detail drawings and specifications contained herein. This publication contains the latest information available at the time of printing. SCAFCO reserves the right to make modifications and/or change materials of any of their products without prior notice or obligation. For the latest information regarding products contact SCAFCO. This document may not be reproduced or distributed in any form, electronic or otherwise, without the express written consent of SCAFCO. In no event will SCAFCO be liable for any damages, including loss of data or information of any kind, lost profits, cost of cover or any other special, incidental, consequential or indirect damages arising out of this agreement or the use or inability to use the details, however caused, and on any theory of liability.

For further information and details on fire ratings and gypsum please see the latest edition of the Gypsum Association GA-600 Fire Resistance Design Manual, or visit www.gypsum.org.

Table Of Contents

Disclaimer	2
Shaftwall Details	
ISOMETRIC WALL DETAIL	4
Vertical Systems Finished One Side	
SW-1H-F1	5
SW-2H-F1	6
SW-3H-F1	7
Vertical Systems Finished Two Sides	
SW-2H-F2	8
SW-3H-F2	9
SW-2H-SC	10
Horizontal Systems	
SW-1H-F1-H	11
SW-2H-F1-H	12
SW-2H-F2-H	13
Corner Details	
SW-2 Outside Corner Detail	14
SW-3 Inside Corner Detail	15

1/2" ProRoc® Type C or 5/8" ProRoc® Type X
APPLIED HORIZONTALLY
1" TYPE S SCREWS 24" O.C.

SCAFCO J TRACK

1" ProRoc® Shaftliner
Type X

SCAFCO I STUD
24" O.C. MAX

1/2" ProRoc® Type C or
5/8" ProRoc® Type X
APPLIED VERTICALLY
1 5/8" TYPE S SCREWS 12" O.C.

SCAFCO J TRACK

FIRE TEST
UL DESIGN U417
SYSTEMS A & C
WHI 651-0306.4 1989

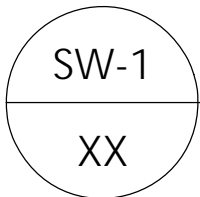

2 HOUR VERTICAL SHAFTWALL SYSTEM
NTS

1" TYPE S SCREWS
12" O.C. FIELD
8" O.C. PERIMETER

SCAFCO I STUD @ 24" O.C. MAX

1" SHAFTLINER

5/8" TYPE X GYPSUM
BRAND AND ORIENTATION
PER GA FILE

GA FILE NO.
WP 7020
WP 6905

SW-1H-F1
XX

SHAFTWALL 1 HOUR FINISHED ONE SIDE
NTS

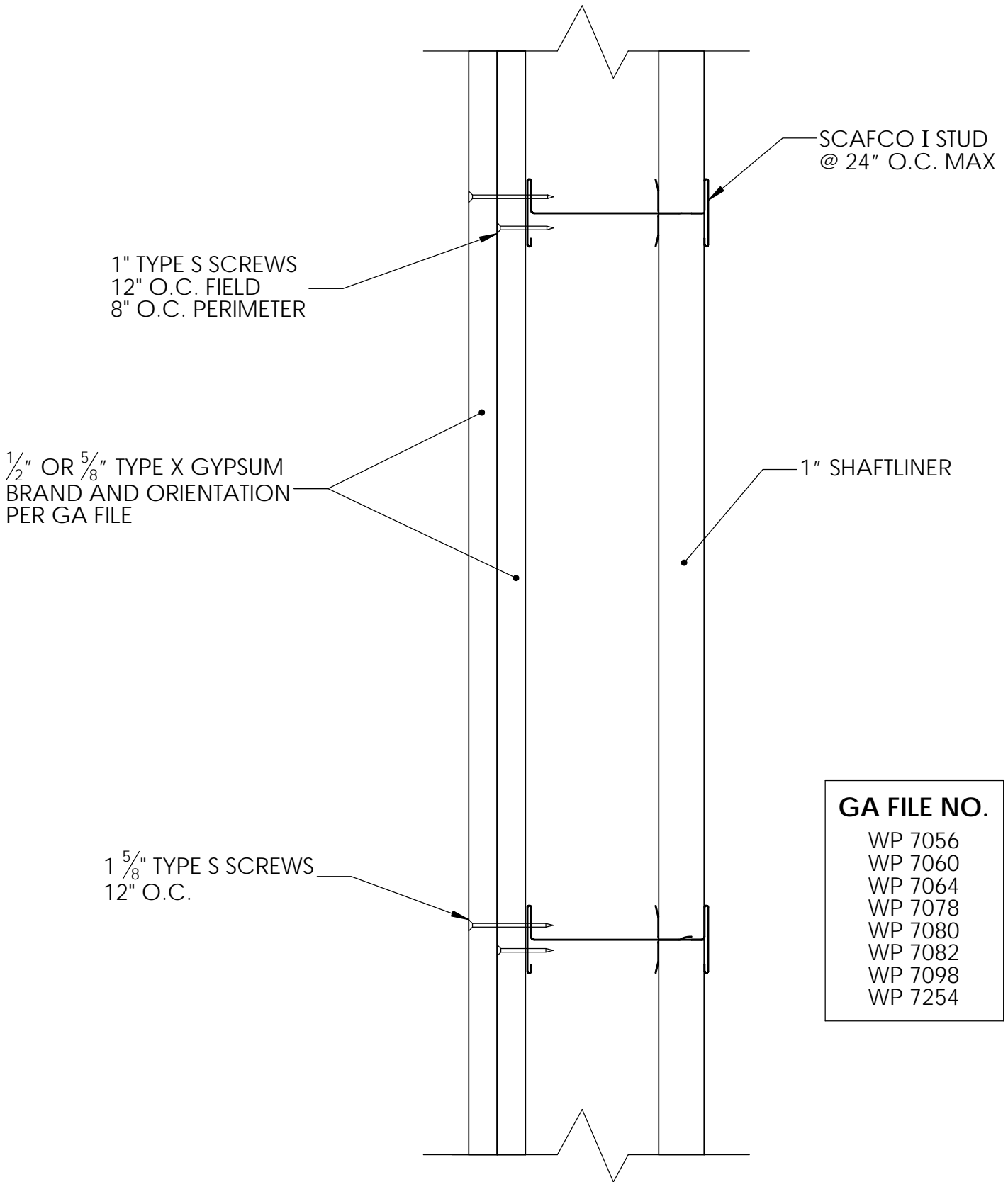

GA FILE NO.
WP 7056
WP 7060
WP 7064
WP 7078
WP 7080
WP 7082
WP 7098
WP 7254

SW-2H-F1
XX

SHAFTWALL 2 HOUR FINISHED ONE SIDE
NTS

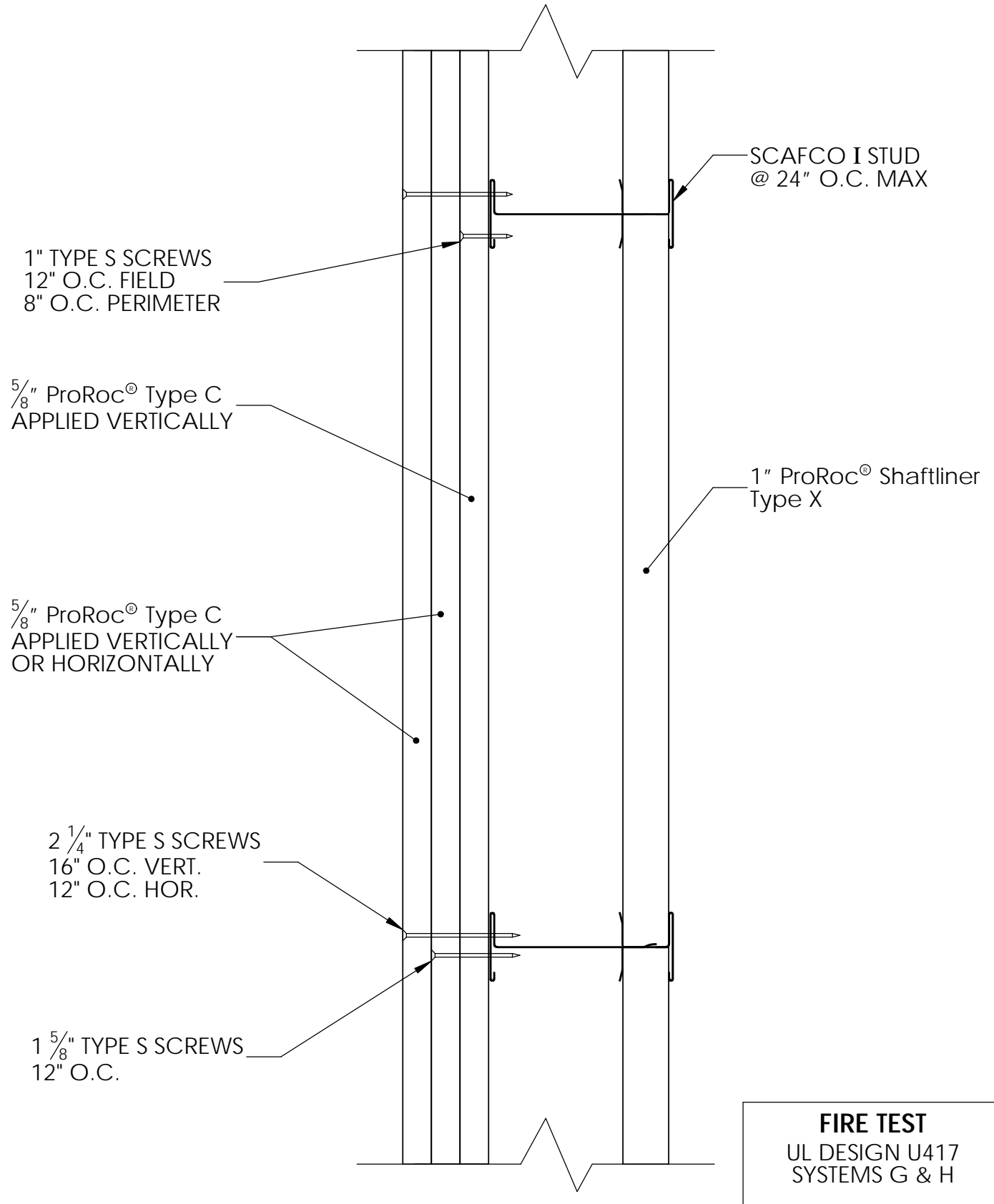

SW-3H-F1
 XX

SHAFTWALL 3 HOUR FINISHED ONE SIDE
 NTS

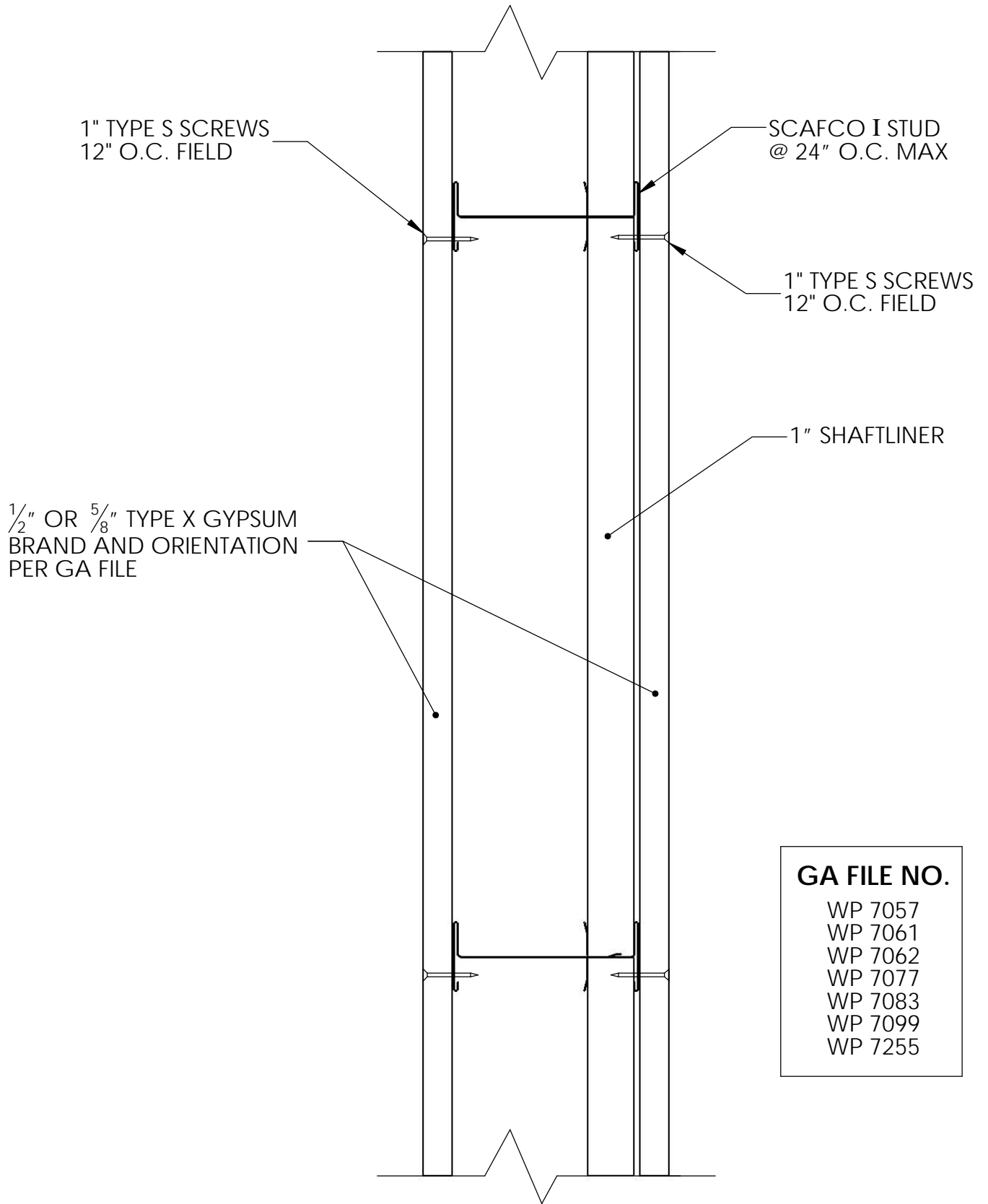

GA FILE NO.
WP 7057
WP 7061
WP 7062
WP 7077
WP 7083
WP 7099
WP 7255

SW-2H-F2
XX

SHAFTWALL 2 HOUR FINISHED TWO SIDES
NTS

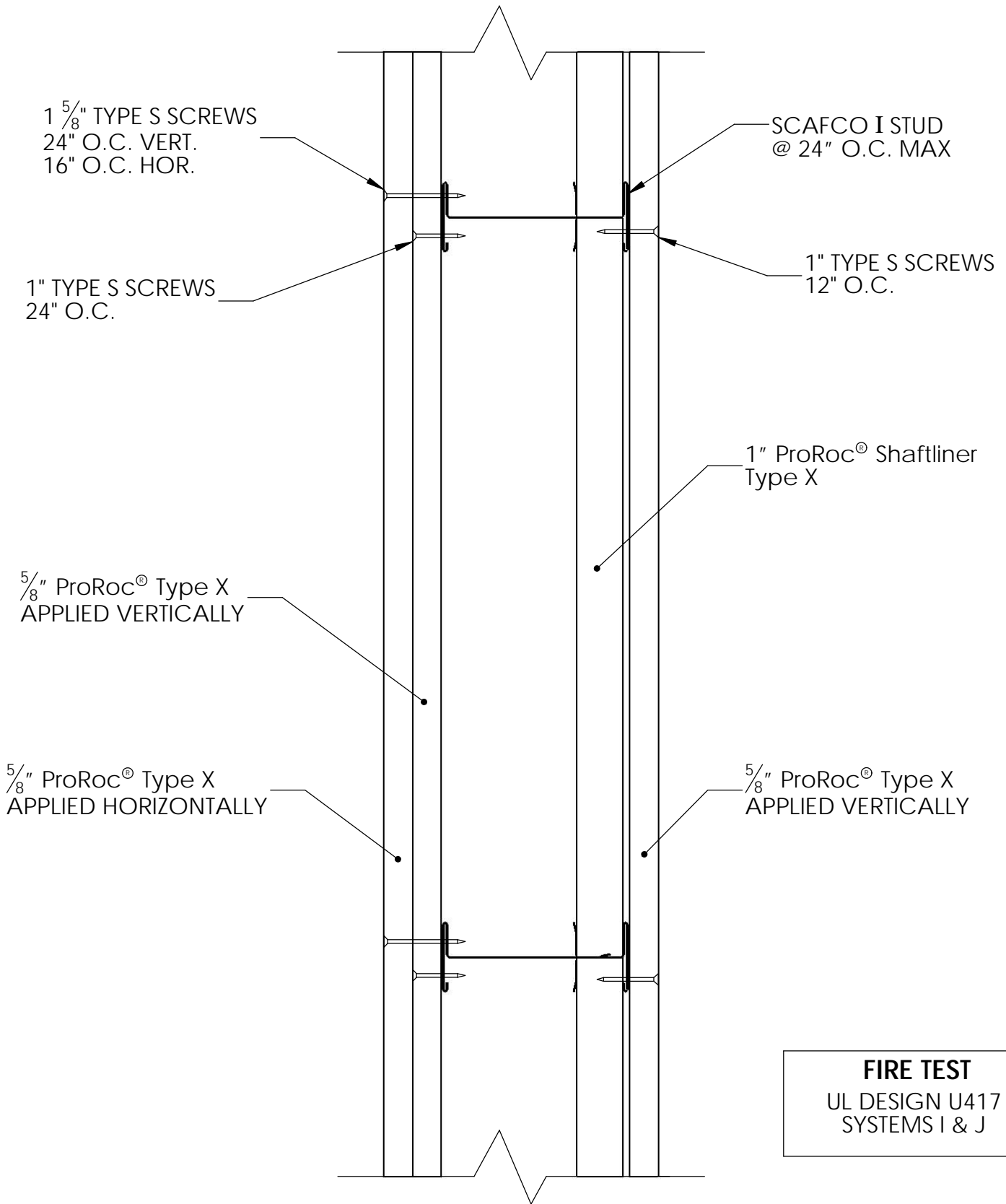

SW-3H-F2
XX

SHAFTWALL 3 HOUR FINISHED TWO SIDES
NTS

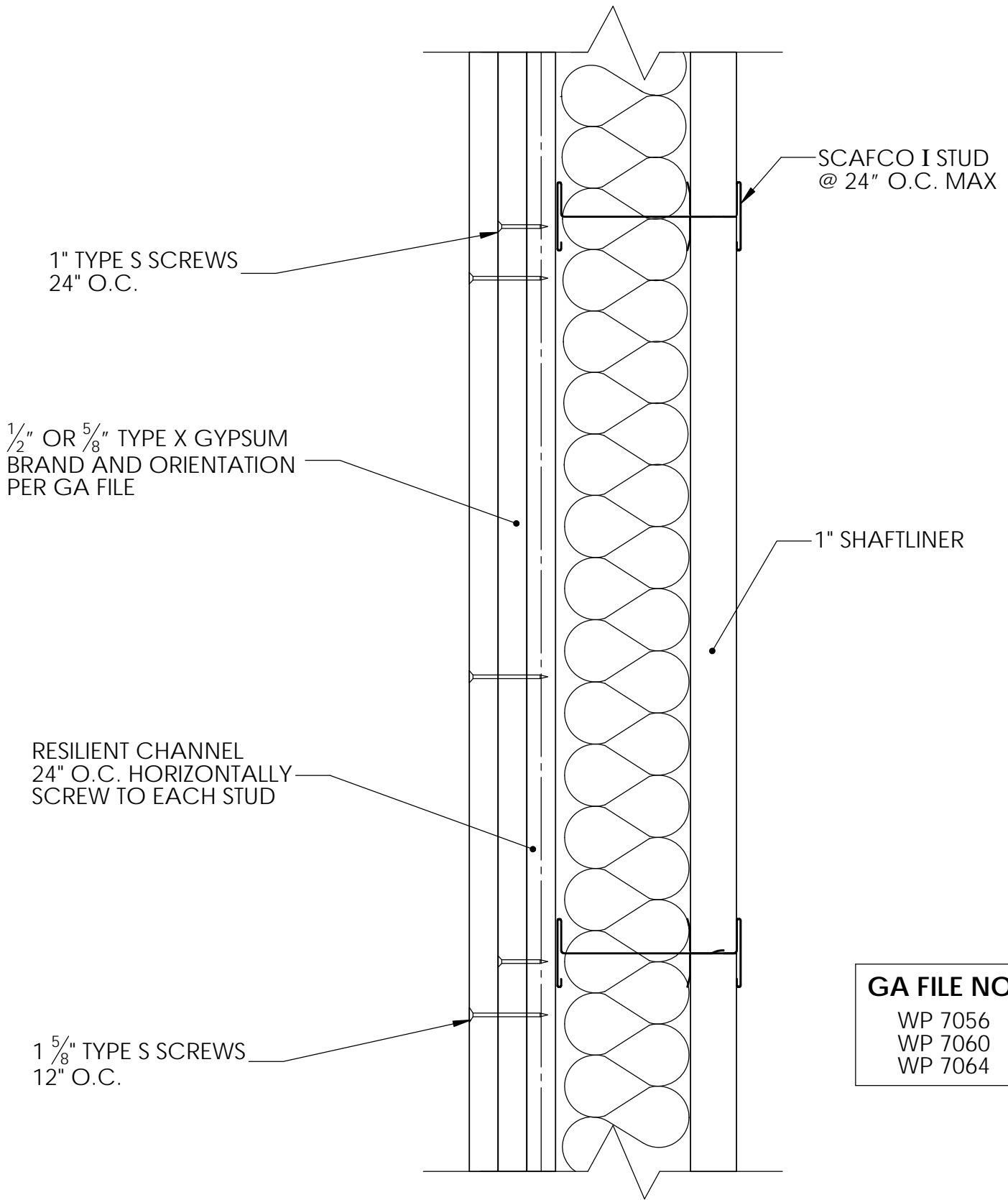

GA FILE NO.
WP 7056
WP 7060
WP 7064

SW-2H-SC
XX

SHAFTWALL 2 HOUR SOUND CONTROL STC 50
NTS

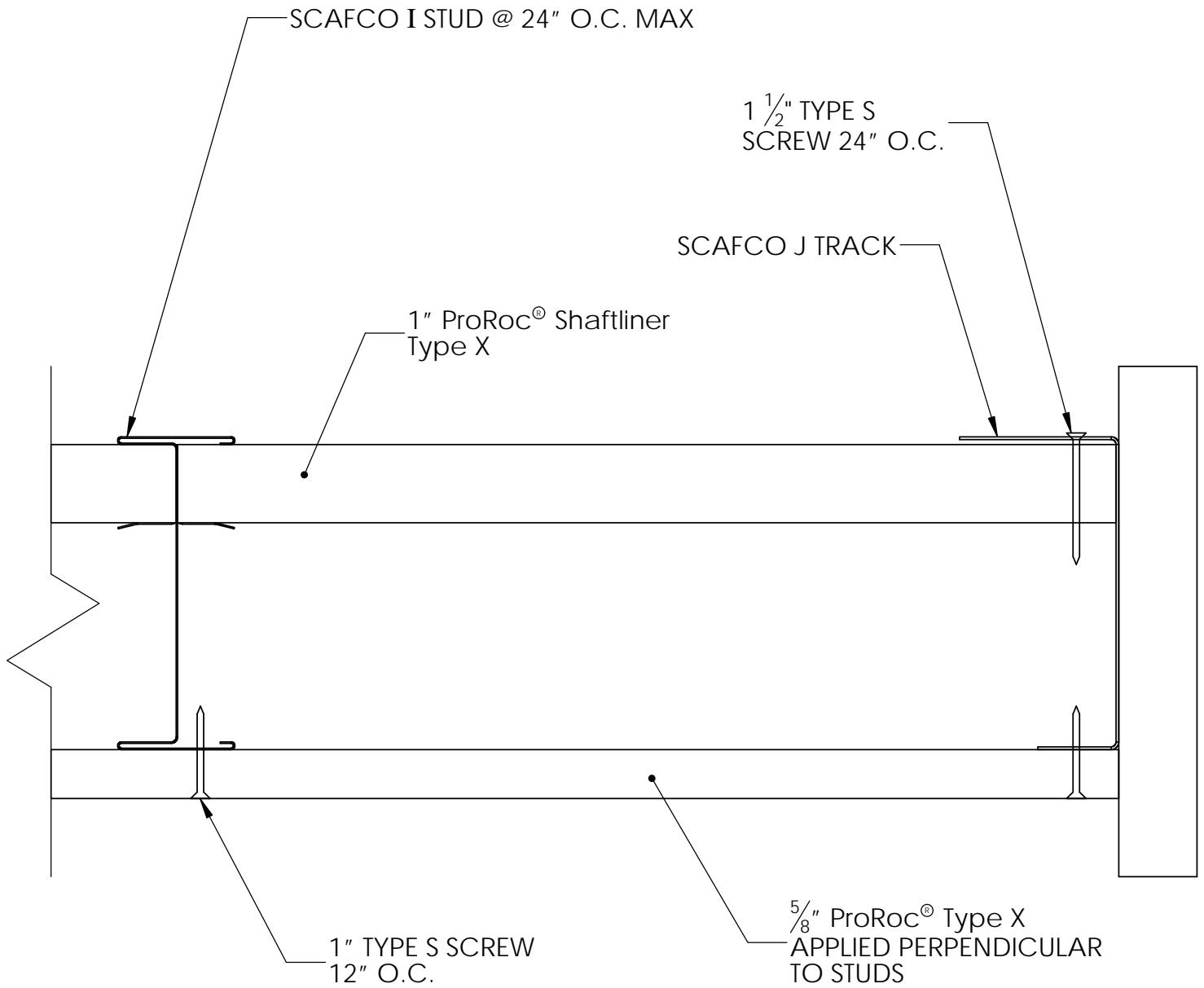

FIRE TEST
 WHI 651-0306.1
 1989

SW-1H-F1-H
 XX

SHAFTWALL 1 HOUR HORIZONTAL CEILING
 NTS

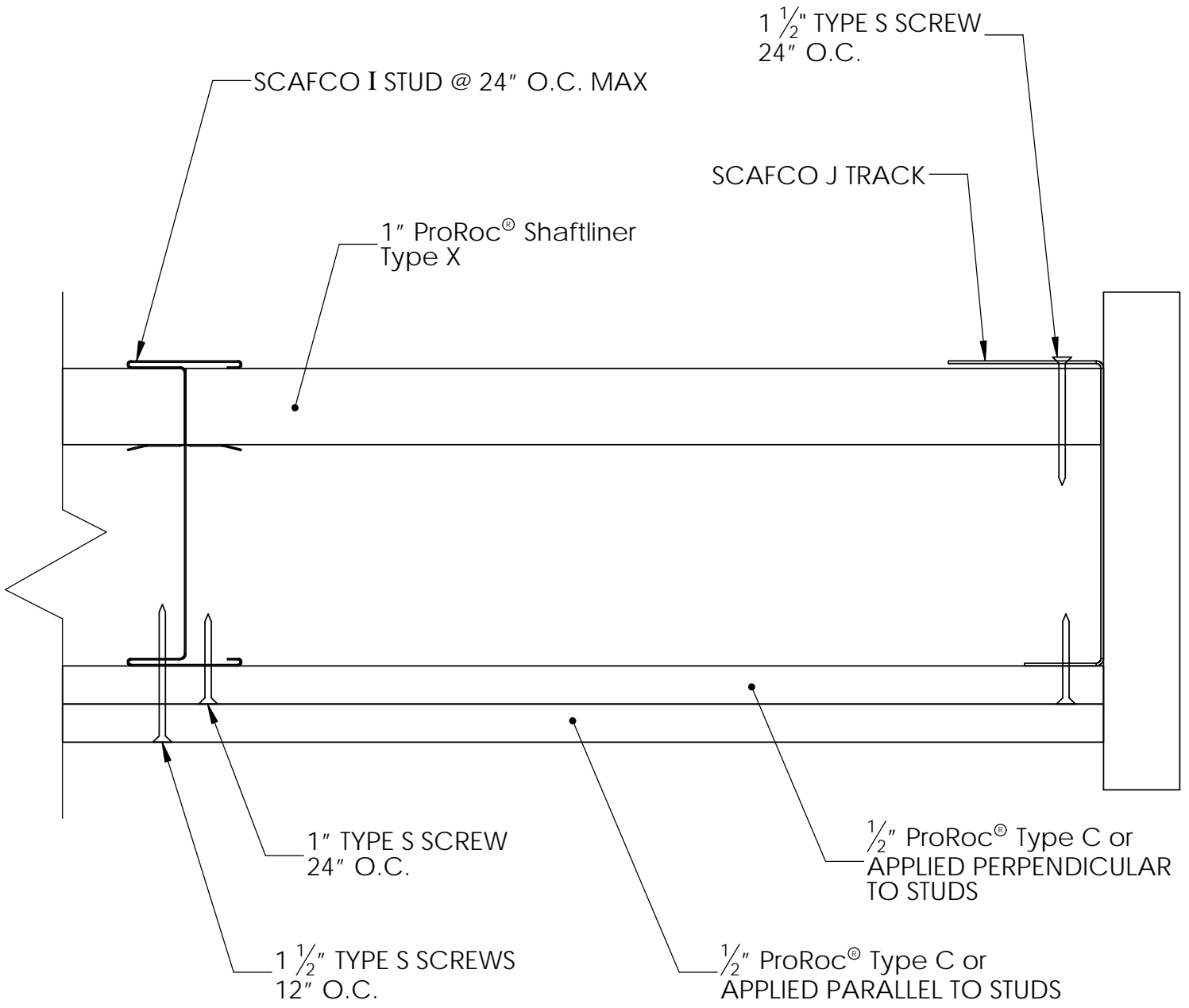

FIRE TEST
 WHI 651-0306.4
 1989

SW-2H-F1-H
 XX

SHAFTWALL 2 HOUR HORIZONTAL CEILING
 NTS

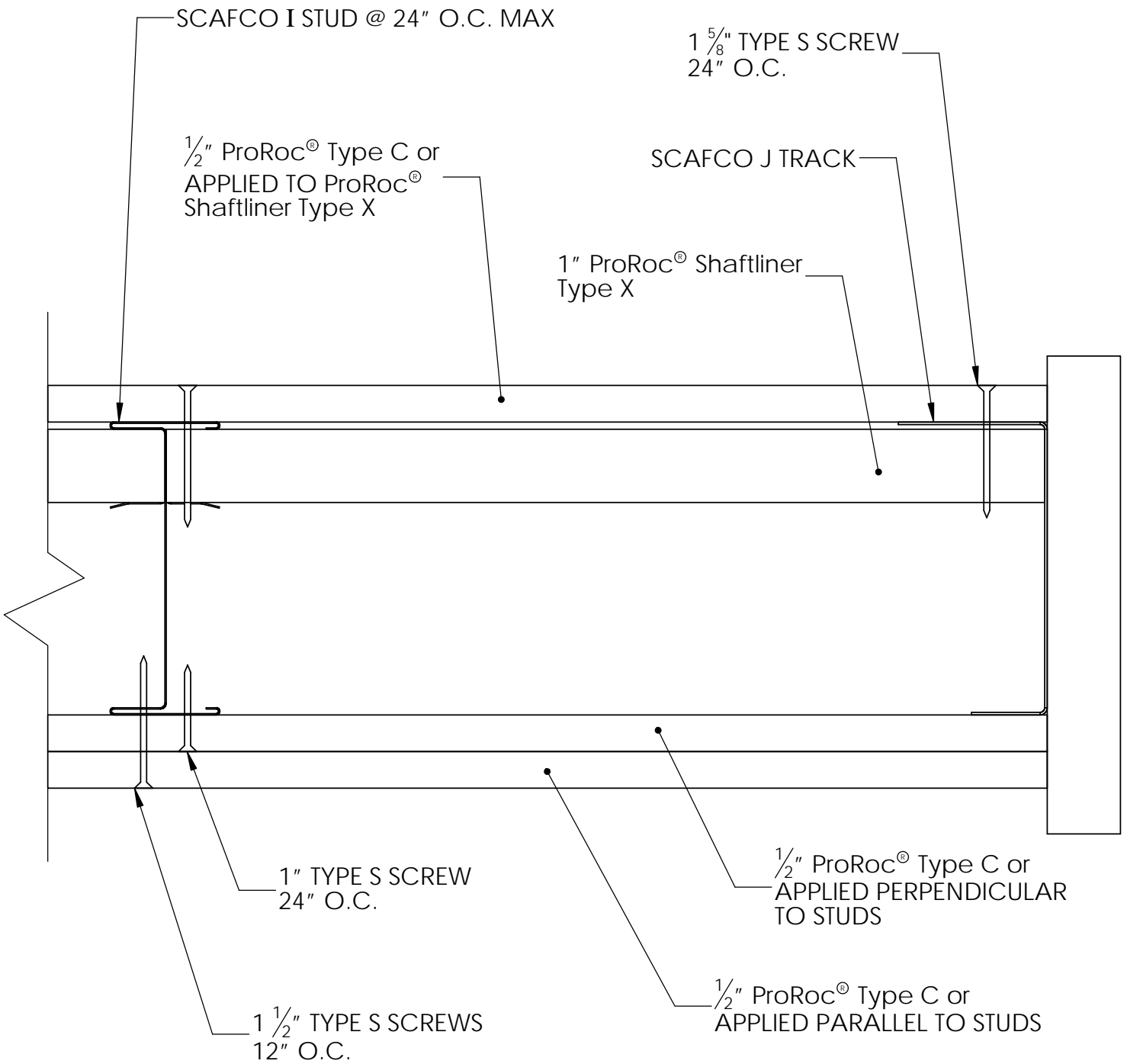

FIRE TEST
WHI 651-0306.4
1989

SW-2H-F2-H
XX

SHAFTWALL 2 HOUR DUCT PROTECTION HORIZONTAL CEILING
NTS

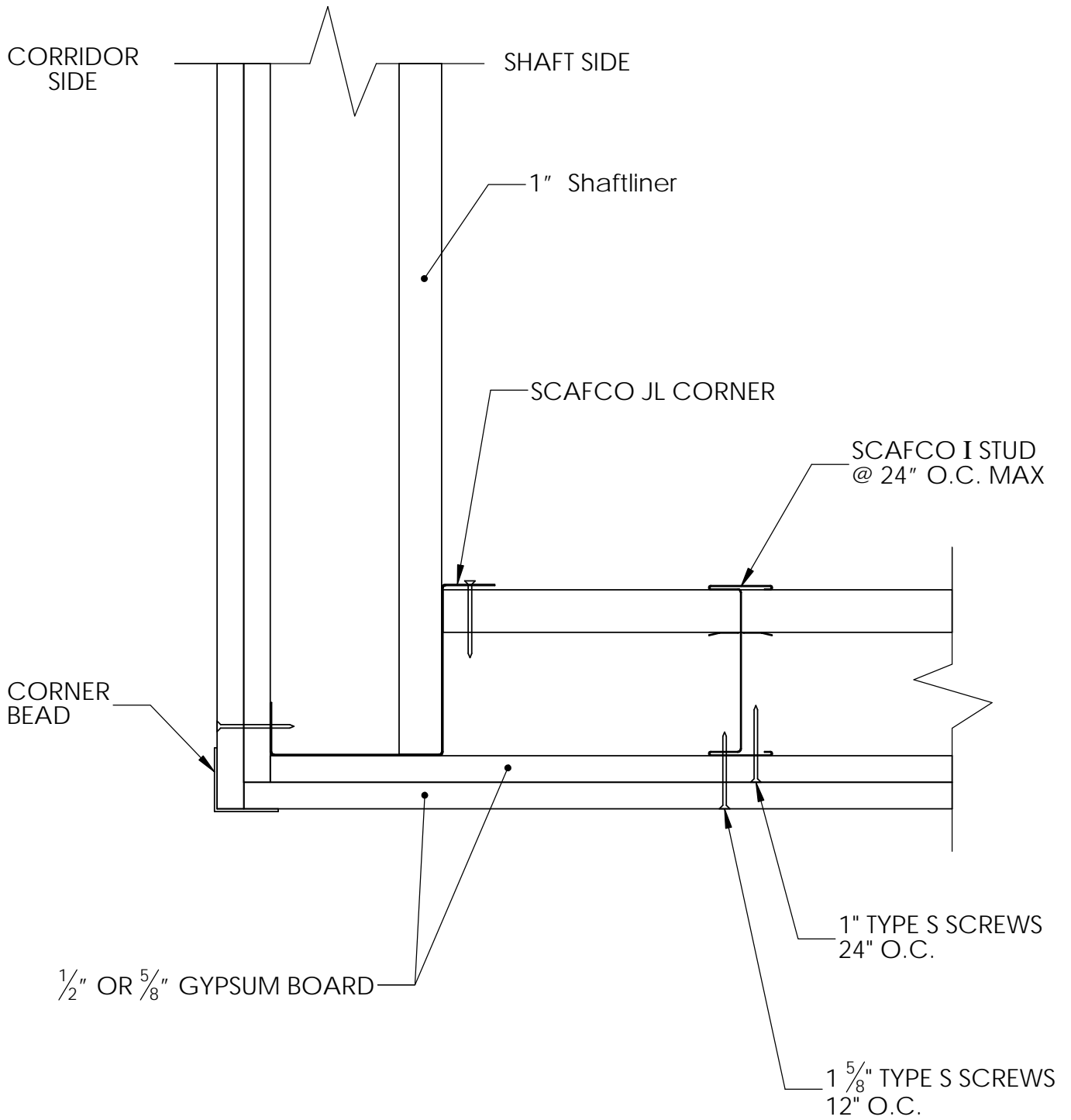

SW-2
XX

SHAFTWALL OUTSIDE CORNER
NTS

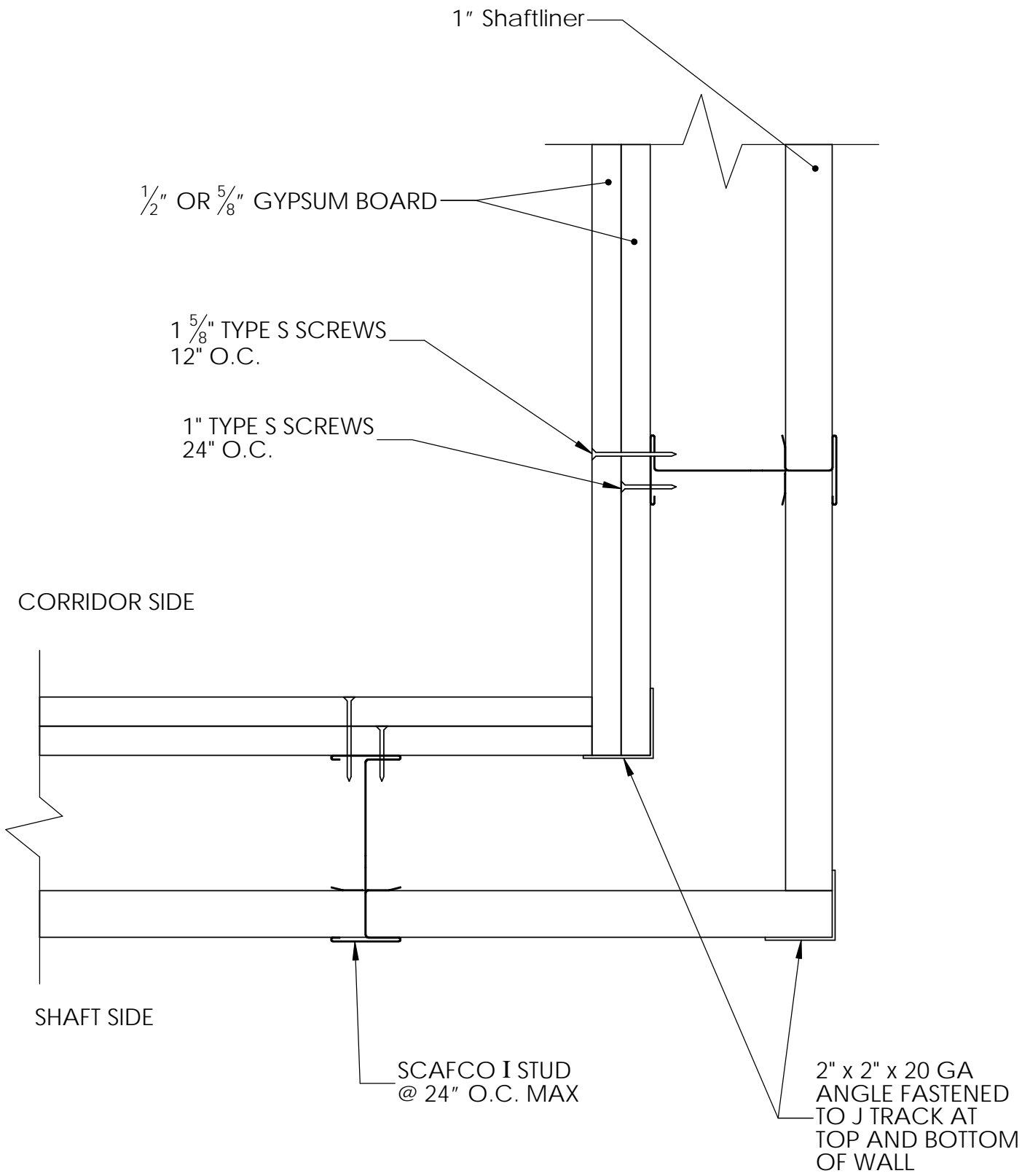

SW-3
XX

SHAFTWALL INSIDE CORNER
NTS